

# Fiber Optic Star Lighting Systems

**Congratulations on your purchase of your new star panel system!**



## PACKAGE CONTENTS

**In this kit you will find the following:**

- Acoustical fiber optic panels
- Epic Link if ordered
- Lead / Booster Wire(s)
- RJ45 Quick Connect Cables
- Power Supply
- High Powered Magnets
- Spacers\*
- Screws
- Marking Pencil

\* Some installers use spacers for standard installation requiring more room for wires.

**Note:** Sometimes there will be more than one lead wire and sometimes the wire(s) will already be attached to the power supply. Lead wires are also used as booster wires to power over 19 panels. (see diagrams on page 3 and 4)

## WHAT YOU WILL NEED

**For a smooth installation we highly recommend the following:**

- Painters tape or a light adhesive masking tape to organize cables
- Appropriate screw anchors for your installation surface (drywall anchors supplied)
- Ladder
- A work buddy

**Note:** Voltage on power supplies varies on the number of panels you are installing. The power supply provided in this package by Epic Sky was determined by your job specifications.

---

## POWER SPECIFICATIONS

### Power Supply:

- 25W
- 45W
- 60W
- 100W

### Number of Panels

- 10 Panels
- 18 Panels
- 24 Panels
- 40 Panels

### Power Supply:

- 150W
- 200W
- 250W
- 300W

### Number of Panels

- 60 Panels
- 80 Panels
- 100 Panels
- 120 Panels

**Note:** If you have more than 120 panels, please contact our customer service department.

**! WEAR LATEX GLOVES TO KEEP PANELS CLEAN WHILE HANDLING!**

## PLUG AND PLAY COMPONENTS



OUR EASY  
PLUG AND PLAY  
SYSTEM MAKES  
INSTALLATION A  
**SNAP!**



Leave the lead wire from the POWER SUPPLY and EPIC LINK RJ45 cable hanging off the side of the first panel so you can connect the next panel. Power supply and Epic Link will be installed above the ceiling.

Connect the lead wire coming from the Epic Link to the starboard. Make sure the RJ45 connector is placed into the IN port first panel you are installing. Connect your shorter jump wire into the OUT port that will lead to the IN port of your next panel to be placed. Refer to wiring diagram on page 3 for connection instructions.

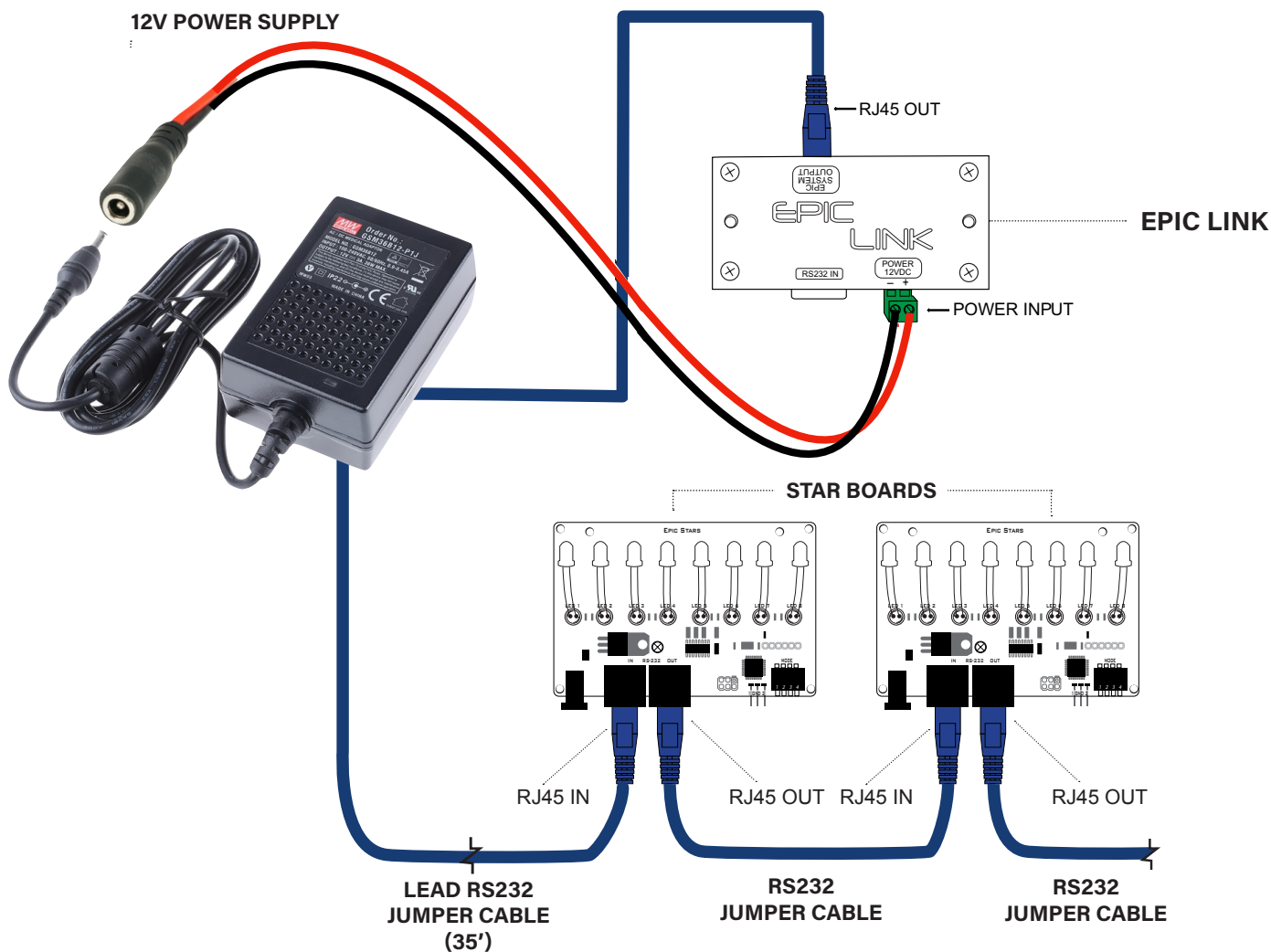

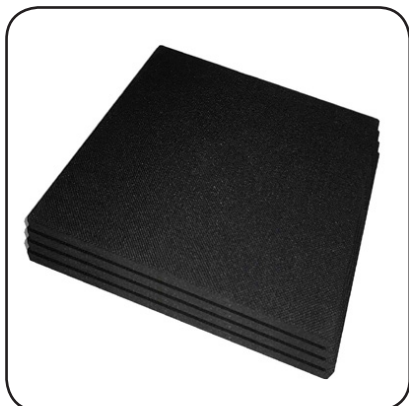

**ACOUSTICAL FIBER  
OPTIC STAR PANELS**

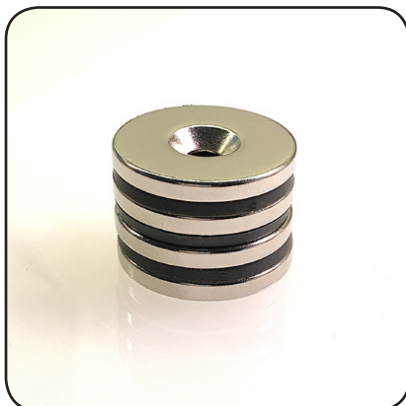

**HIGH POWER MAGNETS**  
**!! READ SAFETY WARNING ON PG. 8 !!**



**MOUNTING SCREWS AND  
50LB. DRYWALL ANCHORS**



**SPACERS**



**LEAD / BOOSTER WIRE**



**RJ45 QUICK  
CONNECT CABLES**



**12V POWER SUPPLY**

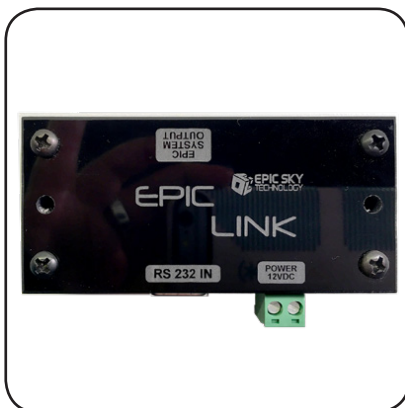

**EPIC LINK**



Up to 12 panels can be connected together in any configuration per lead wire. If your installation requires more than 12 panels, you will need an additional lead jumper wire and may need to add an additional Power Supply and POWER ADAPTER or COMMANDER. See PAGE 1 Power Specifications.

## CONFIGURATION WITH POWER ADAPTER

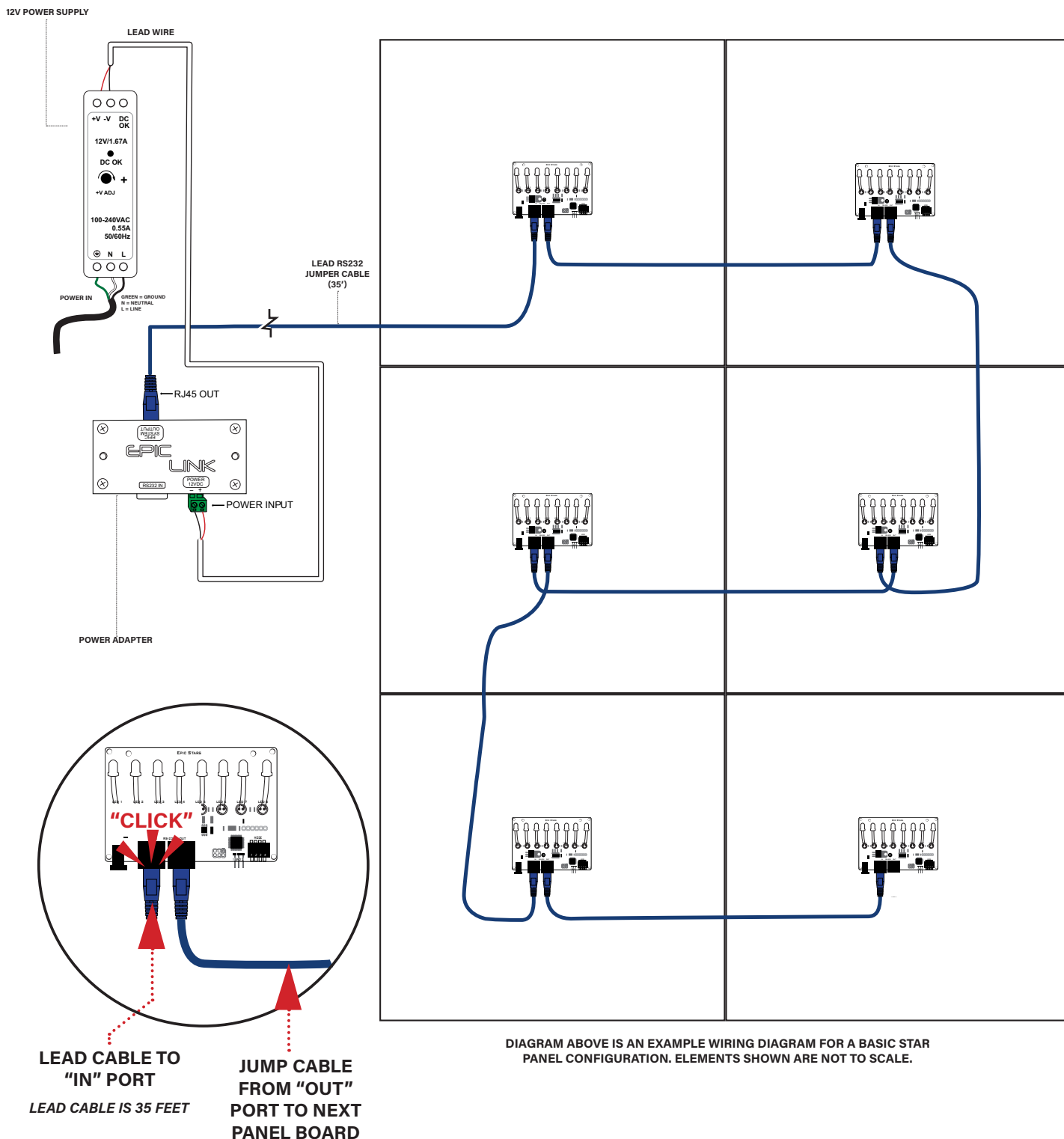

## INSTALLATION STEPS FOR EZ MOUNT PANELS

4



THE MOST IMPORTANT STEP INSTALLING YOUR STAR CEILING PANELS IS STARTING FROM THE **CENTER OF YOUR ROOM AND WORKING OUT.**

1

Find the center of the room by marking out an X from corner to corner

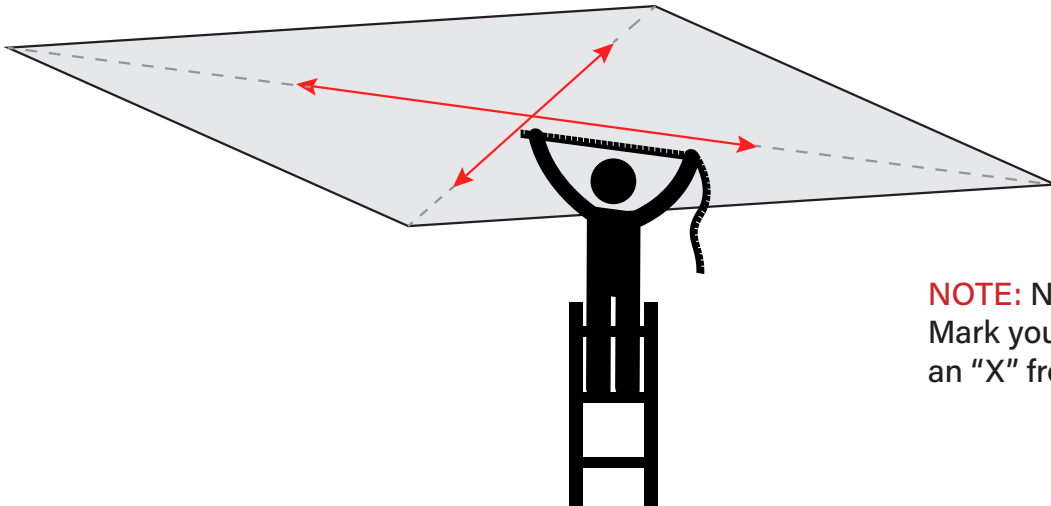

**NOTE:** Not every room is square! Mark your center by marking out an "X" from corner to corner.



**BE VERY CAREFUL WITH MAGNETS:** There is a very strong bond with the provided magnets. Separate them **ONE AT A TIME** by sliding them apart.

2

Take provided screw and slide through center of magnet making sure the screw head is **FLUSH** in the recessed area of the magnet.

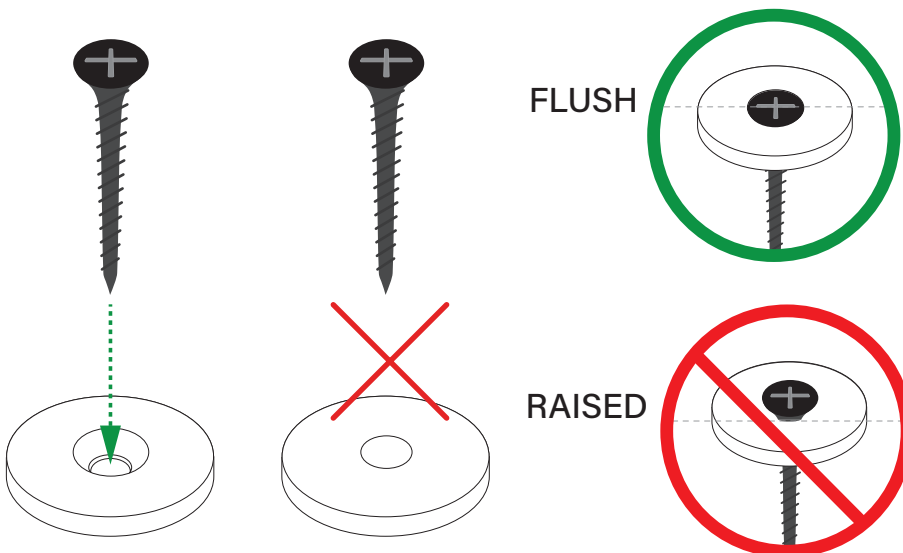

### HELPFUL HINT:

When separating magnets, **slide** apart rather than trying to pull them apart. Use one at a time and keep all screws and metal objects at least 6" away.

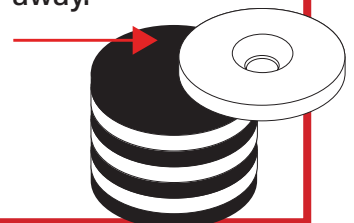

## INSTALLATION STEPS FOR EZ MOUNT PANELS

5

3

Place each assembled magnet and screw in the center of each metal plate on the star panel.

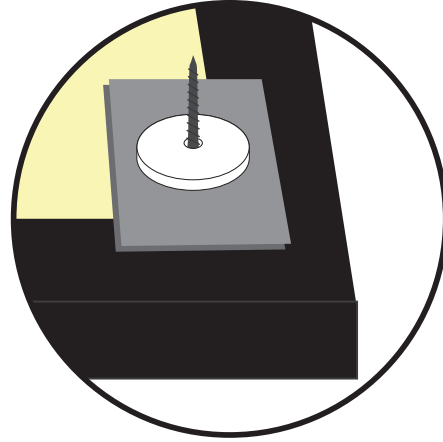
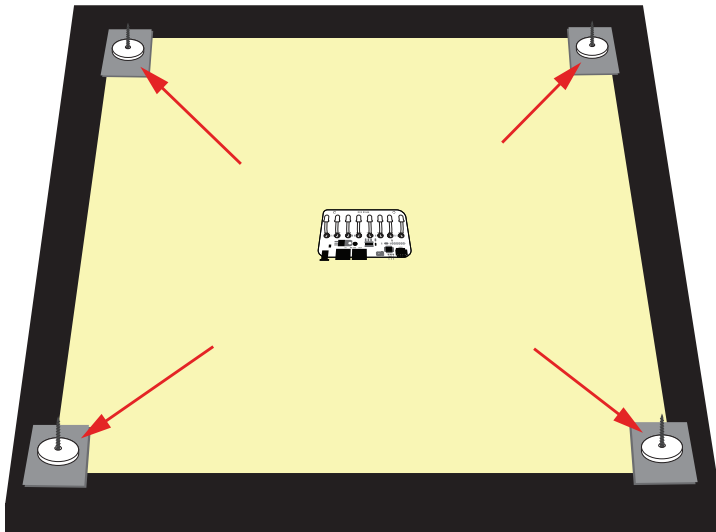

**NOTE:** Center each magnet and marker screw in the middle of each metal plate

4

Hold panel up horizontally to ceiling until all screws lightly touch. With your other hand, make a fist THEN lightly tap each corner of the panel at a 90° ANGLE so that the screw tips make a small indentations.

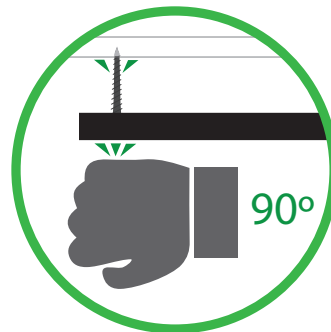
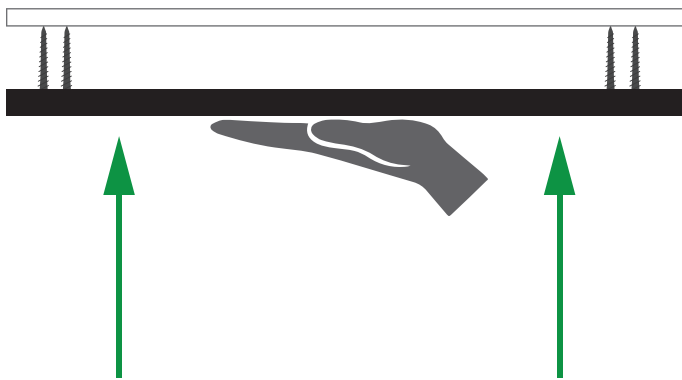

**NOTE:** Be sure to tap at a 90° angle to avoid screws slipping sideways.

## INSTALLATION STEPS FOR EZ MOUNT PANELS

6

5

Place star panel aside and mark the indentations from the screws with a pencil. Screw in provided drywall anchors into your surface on each mark\*

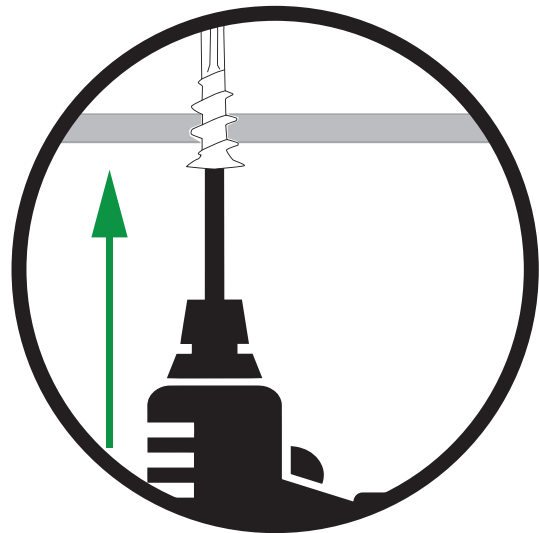
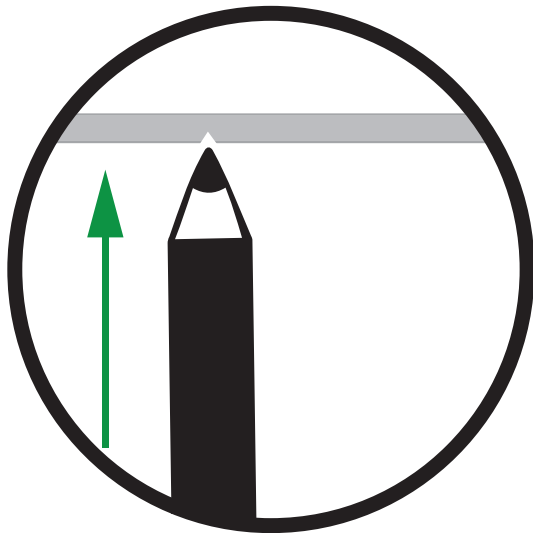

*\* If your installation surface is different than drywall then you must supply and use your own appropriate anchor mounts and/or screws to suit. Failure to do this will compromise warranty.*

6

Carefully remove placed magnet and screw from corner of first panel by **SLIDING** off the metal plate.

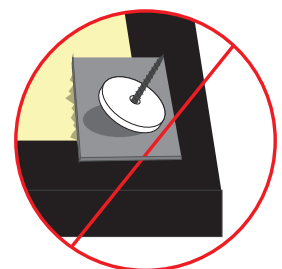
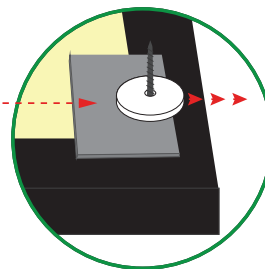
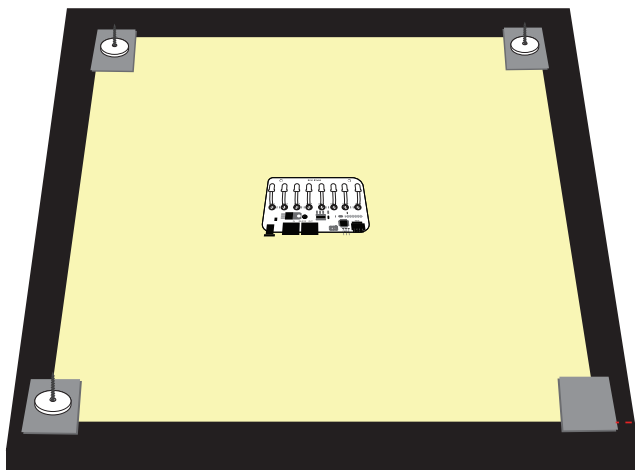

**NOTE:** REMOVE BY SLIDING OFF METAL PLATE. DO NOT PRY OFF.

## INSTALLATION STEPS FOR EZ MOUNT PANELS

7

- 7** Place spacer over screw and fasten to wall. Repeat process until all 4 are in position.

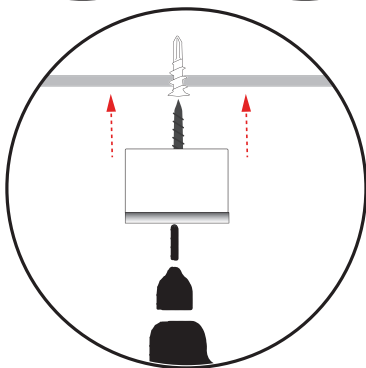
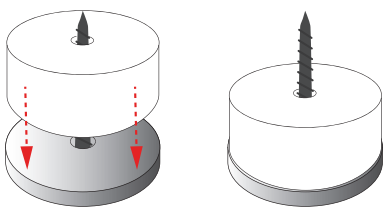

**NOTE:**  
Using spacers  
are optional but  
recommended.

**!! DO NOT OVER TIGHTEN SCREW  
AS MAGNET WILL SHATTER !!**

- 8** From attic, drill hole for cable drop through.

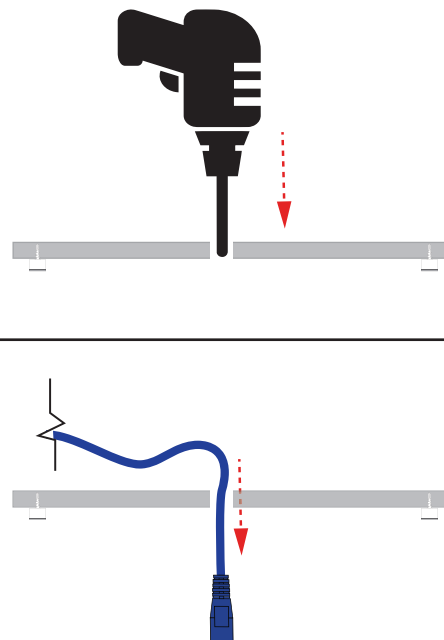

- 9** Connect your RJ45 Quick connect cable from the ceiling to the **IN** port of your first star panel. Take your next RJ45 cable and connect to the **OUT** port and hang off to the side for your next panel

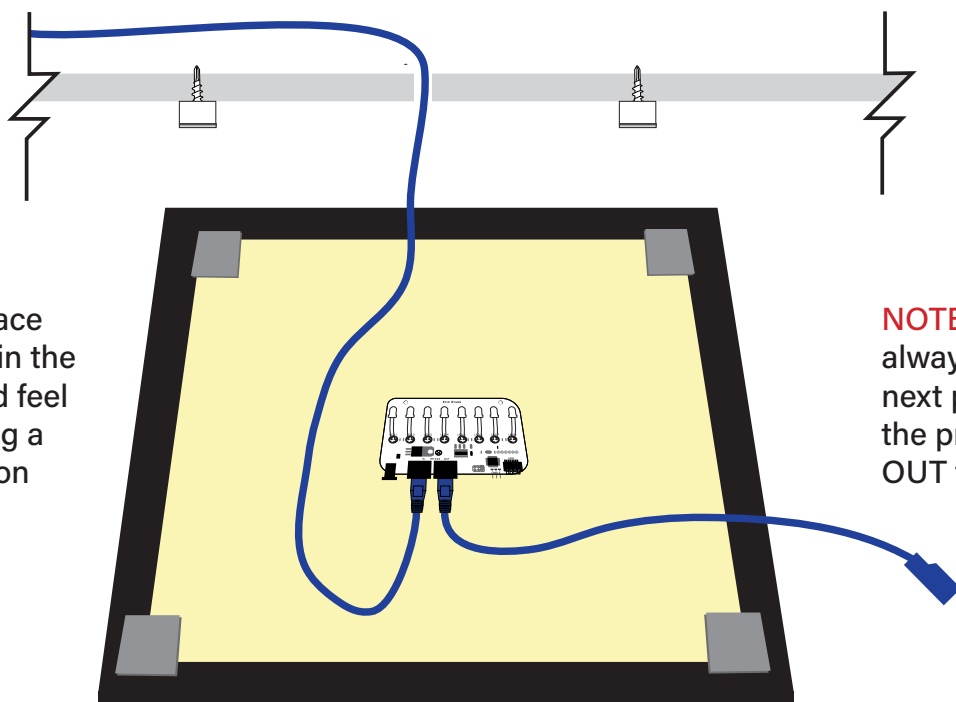

**NOTE:** Firmly place  
RJ45 connector in the  
port. You should feel  
a 'click' indicating a  
secure connection

**NOTE:** Remember to  
always connect your  
next panel cables to  
the proper ports!  
OUT to IN.



- 10** After cables are properly connected on your first star panel, line up under the 4 magnet mounts and slowly raise up to meet the metal plates and let the magnets do their job...**CLICK** thats it!

Adjust panel position if need be by bumping corners with a closed fist.

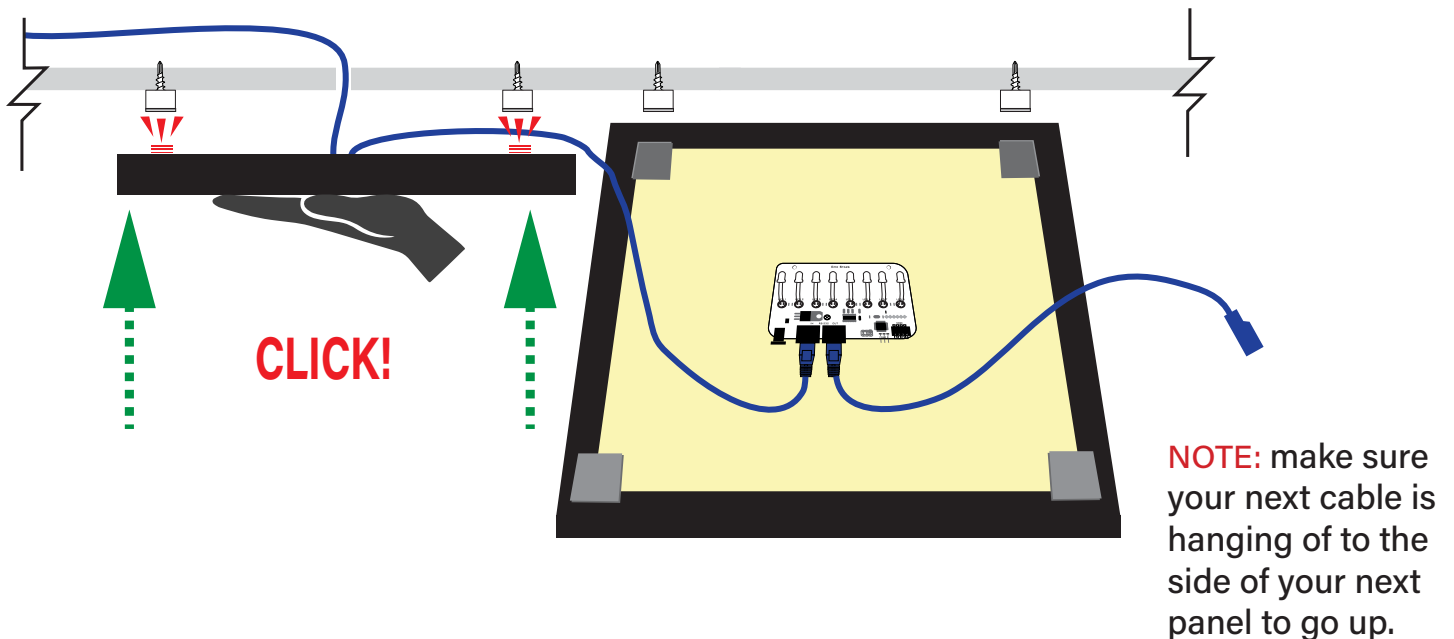

## MAGNET SAFETY

EZ MOUNT MAGNETS ARE VERY STRONG AND BRITTLE.

***DO NOT OVER TIGHTEN SCREW AS MAGNET WILL SHATTER.***

MAGNETS CAN LEAP TOGETHER UNEXPECTEDLY WITH EXTREME SPEED AND FORCE CAUSING POTENTIAL INJURY AND DAMAGE TO THE MAGNETS THEMSELVES.

USE MAGNETS ONE AT A TIME AND KEEP AT LEAST 6 INCHES AWAY FROM OTHER LOOSE METAL OBJECTS AND TOOLS.

KEEP AWAY FROM CHILDREN AND PETS. DO NOT PUT IN NOSE OR MOUTH. MAGNETS CAN STICK TOGETHER ACROSS INTESTINES CAUSING SERIOUS INJURY OR DEATH. SEEK IMMEDIATE MEDICAL ATTENTION IF MAGNETS ARE SWALLOWED . EYE PROTECTION IS RECOMMENDED. DO NOT DRILL OR MACHINE

**NOTE:** Always cut on a flat surface. Spare cardboard works great. Make sure your knife is sharp so you don't tear or pull the fabric

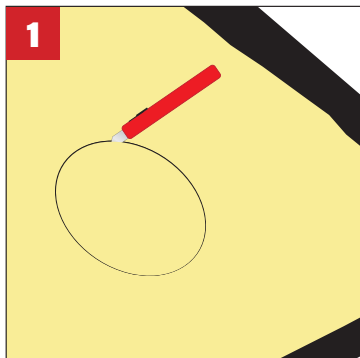

To field cut star panels for protruding objects such as drop beams, canned lights, or air conditioning vents, mark the location of the protrusion on the upper (unfinished) side of the panel. Use a sharp NON-SERRATED knife or box cutter. Cut the desired shape down through the fiberglass but NOT THROUGH THE FABRIC. Set your knife blade. Take your time!

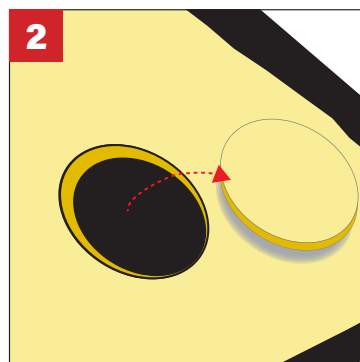

Remove the cut fiberglass piece from the panel.

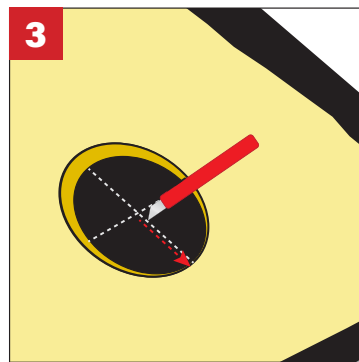

Carefully cut a clean "X" into the center of the fabric.

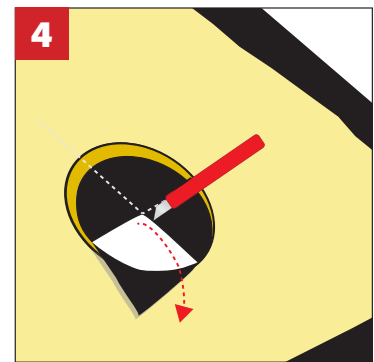

Fold flaps back through the opening.

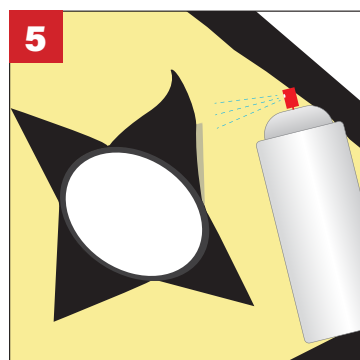

Spray back of loose flaps with a 3M super 77 spray and press flat to surface

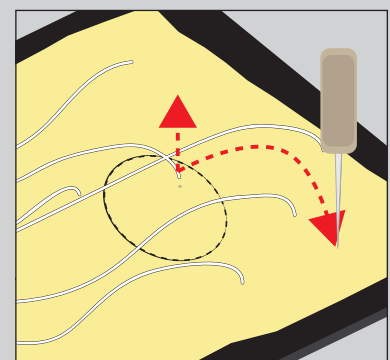
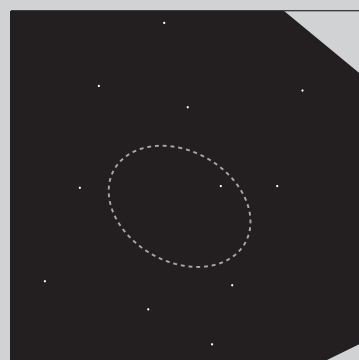

If a fiber or 2 is placed in a location you need to cut out simply cut the fiber, use the poker tool to make another hole in a location you desire, and push fiber through. *(It may not be necessary to do this as each board is populated evenly.)*

The EPIC STAR EFFECTS are determined by the dip switches. The dip switch settings allow you to control a variety of effects including sparkle, scintillation, rain, strobe, etc.).

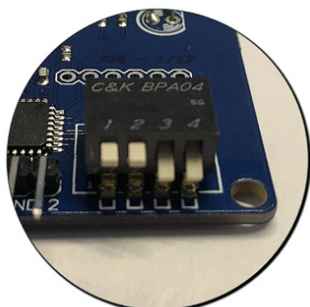

*Shooting Star 10 Min Setting Shown Above*

MODE	SWITCH 1	SWITCH 2	SWITCH 3	SWITCH 4
Night Sky	Up	Up	Up	Up
All on 50%	Down	Up	Up	Up
All On 25%	Up	Down	Up	Up
Meteor Shower	Down	Down	Up	Up
Night Sky 50%	Up	Up	Down	Up
Scintillation	Down	Up	Down	Up
Tropical Winds	Up	Down	Down	Up
Constellation Mode	Down	Down	Down	Up
Shooting Star 10 Sec	Up	Up	Up	Down
Shooting Star 1 Min	Down	Up	Up	Down
Shooting Star 2 Min	Up	Down	Up	Down
Shooting Star 5 Min	Down	Down	Up	Down
Shooting Star 10 Min	Up	Up	Down	Down
Rain Mode	Down	Up	Down	Down
Party (Strobe) Mode	Up	Down	Down	Down
All on 100%	Down	Down	Down	Down
<b>*NOTE*</b>	Epic Star Boards will read the DIP switch setting on power up. Check that the boards are in the right mode <b>before installing</b> in a ceiling.			

All commands must be terminated by a carriage return. All commands are repeated out the serial port to pass to the next controller or device. The "E" symbol means that those command values are stored in EEPROM and will load on power up.

COMMAND	ACTION	NOTES
ess	Night Sky	Night Sky in 3D perspective
ess1	Night Sky 50%	Night Sky in 3D perspective at 50% brightness
es2	Scintillation	Scintillation
es3	Tropical Winds	Tropical Winds - Fast Sparkle
esr	Rain Shower	Stars in Rain Shower mode
est	Party Mode	Stars all on with strobe/fade out pattern
esldxxx *E	Stars on Solid	xxx is the level, 1 - 255, 255 is the brightest
ecn	Constellations on Solid	All LED's on solid - separate than star commands
ecsp	Constellation Sparkle	Constellations sparkle
eco	Constellation Off	Only Constellations turn off
eclvxxx *E	Constellation Solid Level	xxx is the level, 1 - 255, 255 is the brightest
!	Trigger Shooting Star	Immediately trigger shooting star
ssj	Shooting Star 10 Seconds	Shooting Star every 10 seconds, Adjustable via RS-232
ss1	Shooting Star 1 Minute	Shooting Star every minute
ss2	Shooting Star 2 Minutes	Shooting Star every 2 minutes
ss5	Shooting Star 5 Minutes	Shooting Star every 5 minutes
ssz	Shooting Star 10 Minutes	Shooting Star every 10 minutes
sso	Shooting Star Off	Boards in shooting star mode will turn off
ssg	Shooting Star On	Shooting star on
mso	Meteor Shower On	Meteor Shower mode (DIP switches must be set correctly) Default rate is every 2 minutes
msf	Meteor Shower Off	Stops the meteor shower
ssd	Power on Setting	Return to Power on DIP Switch Setting
esdmxxx *E	Dim Setting (stars only)	Brightness level of stars, 1 to 255, Default is 255 (brightest)
espkxxx *E	Star Sparkle Speed	Sparkle Speed, 0 - 255, default is 17, the higher the number, the slower the sparkle
mtspxxx *E	Meteor Shower Speed	xxx is the The Speed of the Meteors in the Shower, 0 - 255, Default is 50 (higher is slower)
mttmxxx *E	Time Between Meteors	Time in 1/10's of a second between each meteor in the shower (0-255) default is 7
mtinxxx *E	Meteor Shower Interval	Time in seconds between meteor showers (0-255) default is 120
mtnmxxx *E	Meteor Number	Number of meteors per shower (1-255) default is 19
ssspxxx *E	Shooting Star Speed	xxx = 0 (fastest) to 254 (slowest), default is 40
sstmxxx *E	Shooting Star Interval	Interval Between Shooting Stars in seconds, 0 - 255, Default is 10
eso	Stars Off	All Stars Off
esn	Stars On	Turns on the stars in the last mode they were in
globaloff	All Off	All Stars off, regardless of mode
<b>NOTE:</b>	The Epic Star Boards will read the DIP switch setting on power up, check that the boards are in the right mode before installing in a ceiling.	